



# ACCESSORY GUIDE



Anterior Arm P/N - 870-000149



Bitewing Arm P/N - 870-000147



Posterior Arm P/N - 870-000148

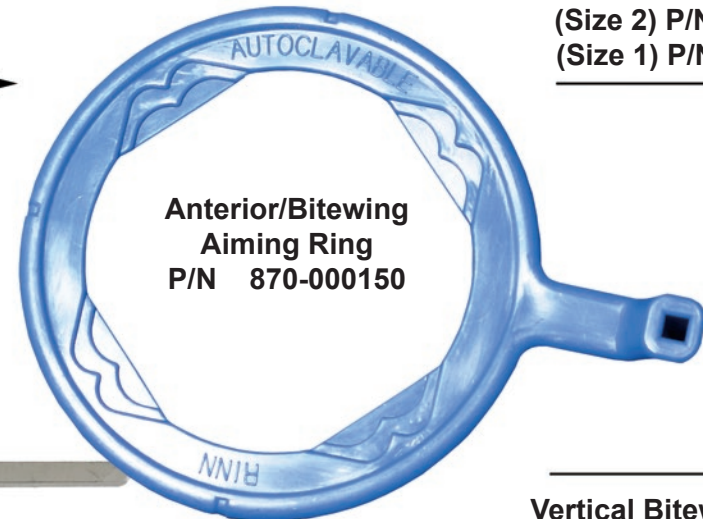

Anterior/Bitewing Aiming Ring P/N 870-000150

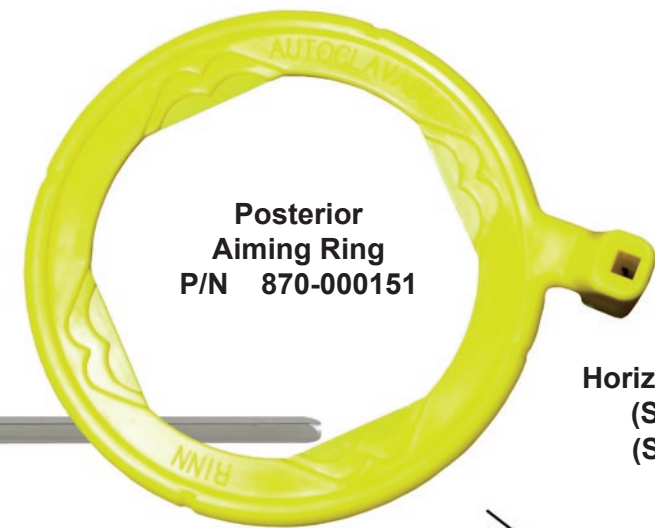

Posterior Aiming Ring P/N 870-000151

Anterior EVA Holder (Size 2) P/N - 870-000121 (Size 1) P/N - 870-000111



Vertical Bitewing EVA Holder (Size 2) P/N - 870-000124 (Size 1) P/N - 870-000114



Horizontal Bitewing EVA Holder (Size 2) P/N - 870-000122 (Size 1) P/N - 870-000112



Posterior EVA Holder (Size 2) P/N - 870-000123 (Size 1) P/N - 870-000113

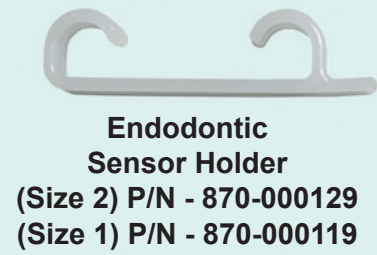
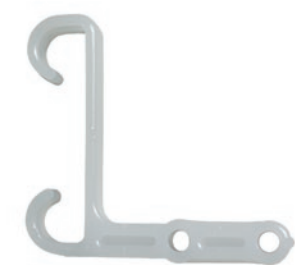

Endodontic Sensor Holder (Size 2) P/N - 870-000129 (Size 1) P/N - 870-000119



Anterior/Vertical Bitewing Block (Size 2) P/N - 870-000125 (Size 1) P/N - 870-000115



Horizontal Bitewing Block (Size 2) P/N - 870-000126 (Size 1) P/N - 870-000116



Bite Wing Holder P/N - 870-000120



Non-Sterile Disposable Protective Sheaths P/N - 870-000088

To reorder please call DENT-X customer service: P/N 870-000088  
**DENT-X**  
250 Clearbrook Rd.  
Elmford, NY 10523  
www.dent-x.com  
An AFP Imaging Company  
Also compatible with Seno-A-Ray Digital Imaging Systems